

Electrofusion fittings: Product Range



Slide-over Couplers



Diameters : 20 to 250 mm
PE 100 SDR 11
Maximum working pressure (MWP)
16 bar (water) / 10 bar (gas)

End-Caps – Diameters 20 to 160 mm



Diameters : 20 to 160 mm
PE 100 SDR 11
(MWP) 16 bar
(water) / 10 bar (gas)

Electrofusion Reducers



Diameters 32 to 160 mm
PE 100 SDR 11
(MWP) 16 bar
(water) / 10 bar (gas)

Elbow 45°



Diameters : 32 to 200 mm
PE 100 SDR 11
(MWP) 16 bar
(water) / 10 bar (gas)

Elbow 90°



Diameters : 25 to 200 mm
PE 100 SDR 11
(MWP) 16 bar
(water) / 10 bar (gas)

FRIALEN®

COMPLY
to BS
EN 12201-3

90° Elbow with base unit

Diameters : 90 / 110 mm
PE 100 SDR 11
(MWP) 16 bar
(water)



T-Pieces with extra long outlet spigot in kit version

Diameters : 25 to 63 mm
PE 100 SDR 11
(MWP) 16 bar
(water) / 10 bar (gas)



T-Pieces

Diameters : 75 to 225 mm
PE 100 SDR 11
(MWP) 16 bar
(water) / 10 bar (gas)



Repair Sleeves

Diameters : 32 to 63 mm
Suitable only for pipes SDR 11



Transition Fittings HD-PE / Brass with male thread

Diameters : 20 to 75 mm
PE 100 SDR 11
(MWP) 16 bar
(water)



Manufactured by STR Marketing Ltd

Certified MS ISO 9001:2015 / Carbon Footprint independently verified by ETC-Africa. A member of the Carbon Protocol of South Africa.

Electrofusion fittings: Product Range



SLIDTransition Elbows 90°HD/PE Brass with male threaded



Diameters : 32 to 63 mm
PE 100 SDR 11
Maximum working pressure (MWP)
16 bar (water)

Flange T-Pieces



Diameters : 20 to 160 mm
PE 100 SDR 11
MWP 16 bar
(water) / 10 bar (gas)

Repair and Reinforcing Saddles



Diameters : 90 to 225 mm
PE 100 SDR 11
MWP 16 bar
(water)/10 bar (gas)

Repair Saddle Top loading



Diameters : 250 mm & above
PE 100 SDR 11
MWP 16 bar
(water)/10 bar (gas)

TraBall Valves in HD-PE, 1/4 turn



Diameters : 32 to 225 mm
PE 100 SDR 11
MWP 16 bar
(water)/10 bar (gas)

Spigot Saddles

Dia : (d1) 63 to 225 mm
(d2) 32 to 160mm
PE 100 SDR 11
MWP 16 bar (water)/10 bar (gas)

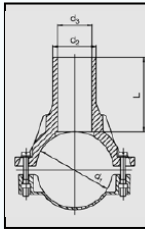

Spigot Saddles Top loading

Dia : Range 250 to 560(d1)
-> 32/63/90mm(d2)
PE 100 SDR 11
MWP 16 bar (water)/10 bar (gas)

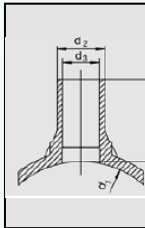

Pressure Tapping Tees with extra long outlet spigot in kit version

Dia : (d1) 63-160mm
/(d2) range 20-40mm
PE 100 SDR 11
MWP 16 bar (water)/10 bar (gas)

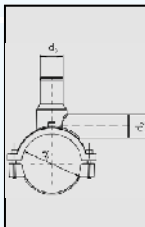

Pressure Tapping Tees with extra long outlet spigot

Dia : (d1) 40-225mm
/ (d2) range 20-63mm
PE 100 SDR 11
MWP 16 bar (water)/10 bar (gas)

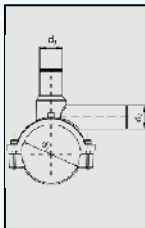

Pressure Tapping Tee Top-loading with extra long outlet spigot

Dia : (d1) 250-315mm / (d2) 63mm
PE 100 SDR 11
MWP 16 bar (water)/10 bar (gas)

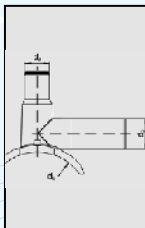

Manufactured by STR Marketing Ltd
Certified MS ISO 9001:2015 / Carbon Footprint independently verified
by ETC-Africa. A member of the Carbon Protocol of South Africa.